



Knockers «FKL in»

Variable impact force and interval.

Properties

- Single or interval impact mode
- Variable impact force and interval
- Lubrication-free
- Flexible range of application
- Can be used up to 185°F, HT version up to 302°F and LT version down to -40° F on request
- Also available with ATEX certification

Field of application

Broad field of application. Knocking off adhering material from container walls such as silos, chutes, filter outlets, reactors and pipelines.

Construction

A piston is forced against a spring by compressed air. With rapid venting, the piston closes against a baffle plate. Knocker housing made of aluminium, baffle plate made of impact-resistant special plastic.

Interval impact mode

The impact depends on the interval time which is set by means of a throttle valve.

The force is adjusted by the three control bores 1 - 3.

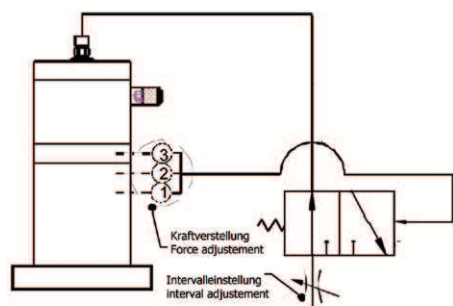

Single impact mode

The impact is triggered immediately after the 3/2-way valve switches. Several knockers can be switched in parallel.

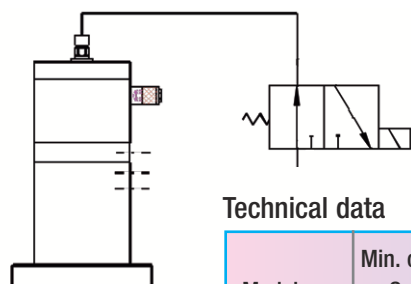

Dimensions

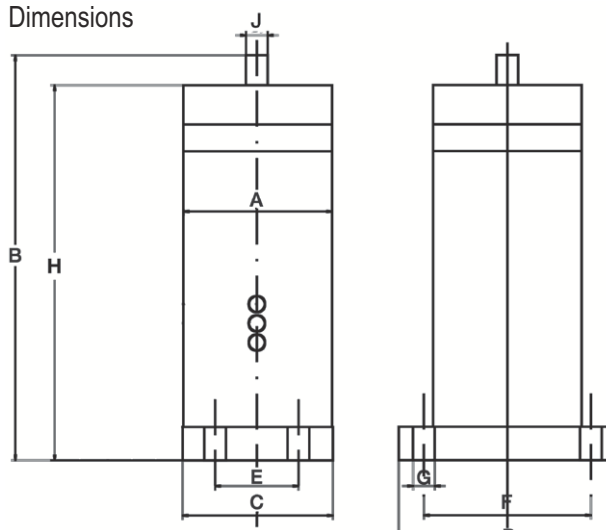

Dimensions in inches

Model	A	B	C	D	E	F	G	M	N
FKL- 25 in	ø 2.05	6.69	2.09	3.46	-	2.76	0.35	6.02	0.51
FKL- 50 in	ø 2.52	7.64	2.60	4.53	-	3.54	0.51	6.97	0.51
FKL-100 in	ø 3.50	9.53	3.54	5.12	1.97	3.94	0.51	8.82	0.51
FKL-150 in	ø 4.65	12.99	-	ø 5.51	-	ø 4.53	0.51	12.20	0.51
FKL 200 in	ø 5.80	13.3	-	ø 7.09	-	ø 5.98	0.67	12.6	0.51

Technical data

Model	Min. op. Pressure (PSI)			Work/Impact Foot-Pounds	Impulse/Impact lbf s	Stroke vpm	Air consumption CF/stroke	For wall thick- nesses up to inches	Weight lb
	①	②	③						
FKL-25 in	43.5	65.3	94.3	0.7 - 5.2	0.11 - 0.23	max. 10	0.02 - 0.32	0.079	2.271
FKL-50 in	43.5	65.3	94.3	3.7 - 15.5	0.23 - 0.79	max. 10	0.28 - 1.08	0.118	4.079
FKL-100 in	58.0	72.5	94.3	7.4 - 51.6	0.23 - 2.36	max. 10	0.48 - 2.69	0.197	9.921
FKL-150 in	76.9	97.2	116.0	36.9 - 144.6	0.23 - 6.53	max. 10	2.39 - 9.34	0.315	20.944
FKL-200 in	76.9	97.2	116.0	73.8 - 206.5	0.23 - 12.94	max. 10	6.62 - 18.52	0.472	32.628